



Emmanuel Messenger

Term 3 | Issue 01 - 20 July 2017

Vision

Through the teaching of God's Word we will bring people to Christ and help them to grow in him.

Mathew 28:19-20

Contents

- Staff Professional Development
- School Policy Updates
- Important Dates
- Emmanuel Bulletin Board
- Information in Brief
- Classroom News

Principal's Message



CHARACTERISTICS OF A CHRISTIAN LEADER (Cont.)

Last term we looked at these characteristics of Christian Leaders: 1. Biblical Servant Leader 2. Authenticity 3. Transparency. We continue to look at Characteristic 4 and 5 this week...

4. COMMUNITY ORIENTED

While it is a biblical truth that each of us is created in the image of the Creator, Scripture points us to community and not to individualism. Before Jesus went to the cross a portion of his final prayer to the Father was the expression of His desire that his children be one in the same way that the Godhead is one. Jesus expressed a desire that his people might live in obedience to God and in harmony with each other. That is intimacy! Paul provides us with another illustration of the vital importance of community. He used the metaphor of the body. He reminded us that no individual body part can function on its own. Every part is of equal value. Every part is to be honoured. To value and honour the various parts with all of their strengths and weaknesses requires that the community be grace-filled. A biblical leader is community minded, Instilling a sense of community is essential for the School Board, the staff, students, and the general school community.

Effective leaders understand the value of lifelong learning, model it and instil the value within the staff. Effective leader creates a team within the staff and builds a community that works, serves, and learns together.

A chapter in the book 'Schools As Communities' (Bruce Hekman) is entitled 'Communities of Grace'. Not only must leaders be community minded, but they must also develop a sense of the nature of biblical community in a Christian school. The nature of authentic Christian school community is characterized by the attributes of grace, mercy and peace. Leaders of grace-filled communities understand that communities will be broken, but in Christian community restoring what is broken is an intentional goal of the leader.

5. COMMUNICATOR

The Church and the Board are entrusted with the mission of the school. The school leader is empowered to articulate and champion this to the various constituencies of the school. One-on-one and small group communication is a necessary skill. It is critical for the Christian school leader to be equipped to tell the school's story to prospective parents, media, community leaders, etc. What's the "soul" of the school? What is the school accomplishing? How does the school's story connect to the Kingdom of God? Effective communication comes in various forms. The effective Christian school leader will assess his or her own gifts. If his gift is speaking, then speak. If her gift is writing, then write. The effective Christian school leader understands that communicating the mission of the school is an essential and ongoing task of the leader.

to be continued...

STAFF PROFESSIONAL DEVELOPMENT

While Students were enjoying a winter break, Teachers, EA's and Admin staff were busy, preparing for the new Term at Emmanuel.

Staff attended a number of Professional Development courses in the break. On Thursday 13th July, all staff attended a course in dealing with people, presented by Justine Humphries from Vose Seminary. Staff listened, discussed and learned about brain responses, confrontation, de-escalation and restoration in human relationships.



On 17th July, All staff attended the annual state CSA conference at the Perth Convention & Exhibition Centre. The theme across the keynote sessions was 'HOPE'. Staff were challenged by Dr Rod Wilson who asked "where does your hope lie"? We were encouraged to consider that only in the depths of anguish, the greatest hope can be found.

There were many choices for smaller group topics and network meetings in which information could be shared among Christian staff

On Tuesday 18th July Emmanuel hosted a professional development course for 50 teachers from various metropolitan schools and 20 of our own teachers and EA's.

Dr Lorraine Hammond from ECU delivered the lecture and teacher Kate Brand, gave an example of how this instruction looks in the classroom.

Attendees met from 8.30am to 12.00pm. It was an intensive and often fast paced delivery, which challenged staff and got many of us thinking and taking about pedagogy, classroom management and spelling!

The session was about SRA Spelling Mastery and the use of both Direct Instruction (DI) and Explicit Instruction (EI) for the learning and remediating of spelling skills



SCHOOL POLICY UPDATES



Hairstyle Information

Hairstyles for boys and girls should be neat, natural in colour and conservative in appearance. Hairstyles such as the mohawk, dreadlocks or patterns/pictures shaved into the hair are not acceptable.

To maintain neat, safe hairstyles, students with hair longer than the shirt collar must have it tied back using plain blue hair ties such as: elastics, headbands, clasps or ribbons.

The acceptability of any hairstyle is at the discretion of the Principal and students will be expected to adjust their hairstyle as he directs.

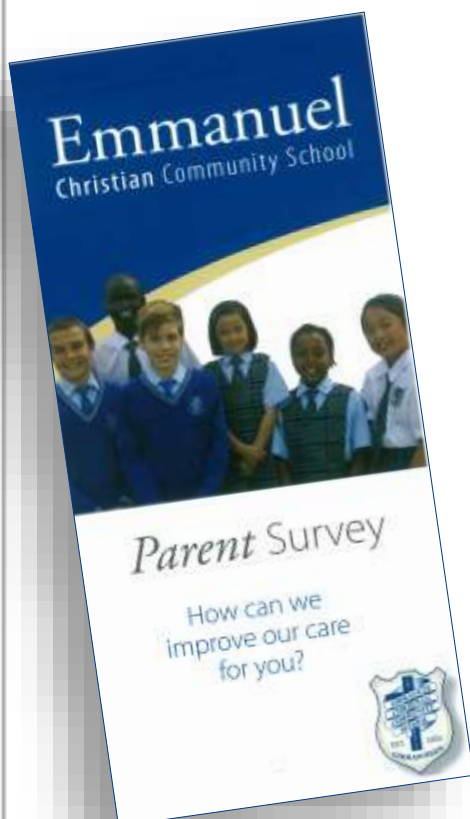

Thank you to all parents who completed a Parent Survey in Term 1. The School Principal, Mr Cruz has taken time to go through each one, compiling results and taking note of the suggestions and comments written down. As a result of the Parent Survey, the following change is being made to our **Parental Complaints Policy**. (for the full policy, please refer to the Parent Handbook)

How should I complain?

- *When you contact the School, ask to speak with the person with whom you have a grievance, if it is possible. If it is not possible, the next person you should contact is the School Principal. Be as clear as possible about what is troubling you. **You may like to ask someone to come with you for support.***

IMPORTANT DATES

TERM 3

WEEK 1	MON-TUES	17 –18 JULY	CSA CONFERENCE AND STAFF DEVELOPMENT
WEEK 1	WEDNESDAY	19 JULY	TERM 3 COMMENCES
WEEK 2	THURSDAY	27 JULY	NAIDOC WEEK ASSEMBLY
WEEK 3	THURSDAY	3 AUG	YEAR 6 ASSEMBLY
WEEK 4	THURSDAY	10 AUG	YEAR 4 ASSEMBLY
WEEK 5	WEDNESDAY	16 AUG	GRANDPARENT/MULTICULTURAL DAY
WEEK 7-8	MON-FRI	28 AUG	2 WEEKS SWIMMING LESSONS PP to YEAR 2
WEEK 7	WEDNESDAY	30 AUG	KINDY KANGAROO ASSEMBLY
WEEK 7	THURSDAY	31 AUG	YEAR 5 ASSEMBLY
WEEK 9	MONDAY	11 SEPT	PARENT NIGHT 5:30—7pm
WEEK 9	THURSDAY	14 SEPT	PRE-PRIMARY ASSEMBLY
WEEK 9	FRIDAY	15-22 SEPT	YEAR 6 CAMP
WEEK 10	THURSDAY	21 SEPT	END OF TERM 3
	FRIDAY	22 SEPT	STAFF DEVELOPMENT

All Upper School traffic MUST enter Salcott Road here

Location Map and traffic flow

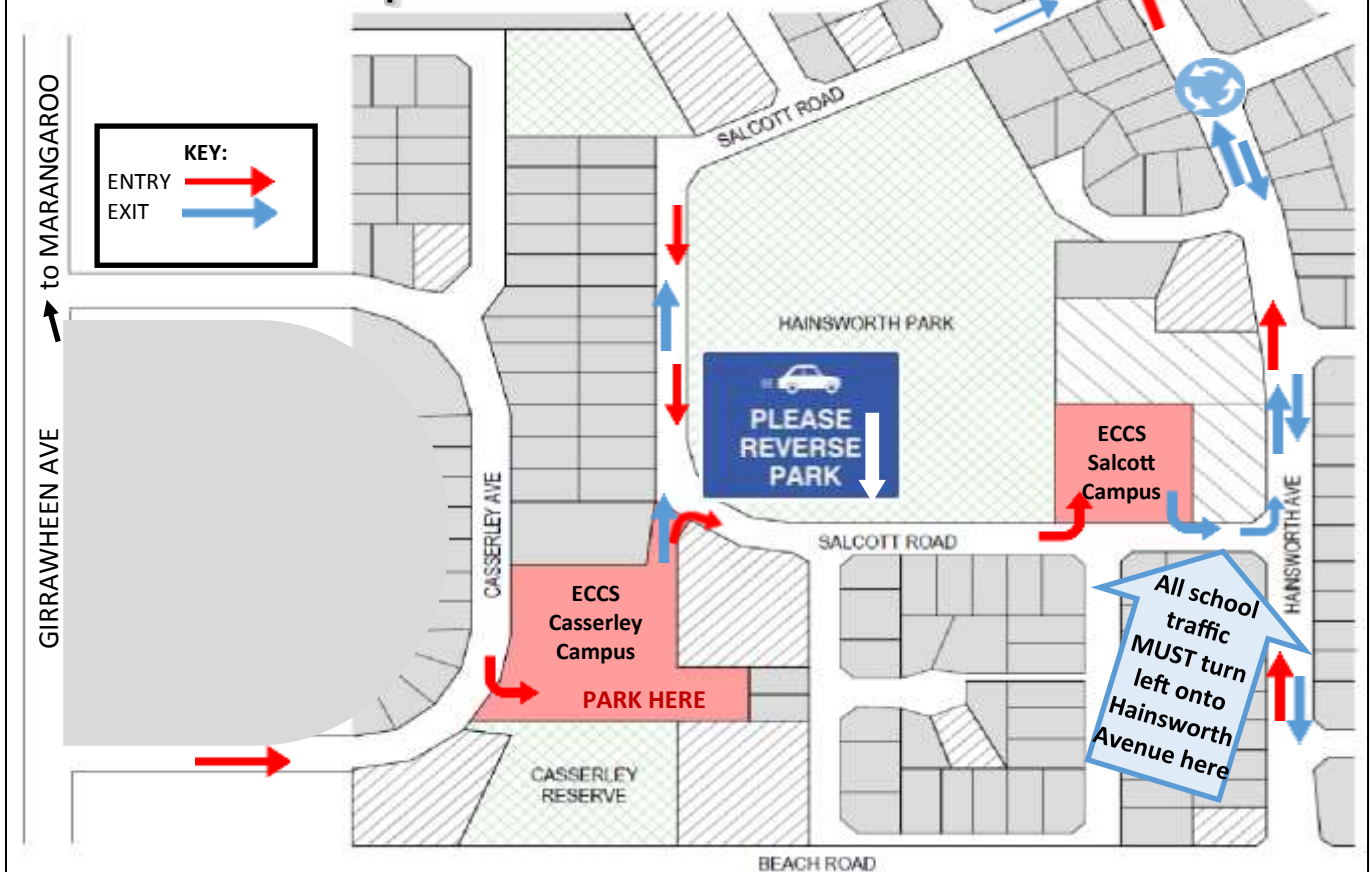

EMMANUEL BULLETIN BOARD

Uniform Shop Update



We are SO thankful for the helpful service of Michelle Manuel & Myshelle Bowman in the uniform shop for the past 4 years.



Welcome!



We warmly welcome Maree Concha (Left) and Jenny Truong (Right) who are taking on the positions in the Uniform shop. Thank you for your patience and support as they settle in at such a busy time in the life of Emmanuel.



The uniform Shop is opening for an extra half hour every Thursday. Opening times are:

MONDAYS 8:30—9:30am

THURSDAYS 2:30—3:30pm.

Order forms with payment can be left at the office out of opening hours. The uniform shop can also be contacted via email at uniform@eccs.wa.edu.au. Please remember **CASH ONLY!**



CONGRATULATIONS!!

Our Bursar Dylan Teng and his wife Miyako have welcomed their 2nd baby daughter Frances Akari Teng on Monday 10th July. Frances is a new sister to Rachel (2 years old). We give thanks to the Lord for her safe arrival and trust Dylan enjoys a few weeks at home with his young family.



JCE

Junior
Christian
Endeavour

WHO? All kids from Kindy to grade 6.
WHEN? Every Friday during School term
TIME? 5:30—7pm
WHERE? Girrawheen Baptist Church premises
WHAT? Meet other friends and learn more about Jesus in a fun and loving environment.
BRING? Your Friends!

INFORMATION IN BRIEF



Sibling Enrolments—If you have younger children who are not yet enrolled in Emmanuel, come to the office for an enrolment form to ensure their place.



Uniform Shop—is open every Monday morning (8:30-9:30am) and Thursday afternoon (**2:30-3:30pm**).



Art club—Yrs 5—9 Tuesday afternoons from 3:15-4:00pm. Permission slips in the Office.

Subway Lunches—Forms to be returned by THURSDAY morning. Lunch delivered every Friday.

Subway lunches will resume WEEK 2



Choir Days—The GOSPEL Choir (Y3-6) meets on *Wednesday* afternoons 3:20—4:10.



The Senior Choir (Y7-9) meets Thursday mornings at 7:50am

School Banking—Every Thursday morning from 8am to 8:30am at BOTH campuses. Come and visit for more information.



Homework club—Thursday afternoons from 3:20-4:15pm. Collect a form from the office for the new term and complete with Parents signature.



Parents Prayer group—Every Friday morning 8:45-9:15 in the Church hall. Come and join us in prayer for our School Community. Young Children welcome



Social Media—Please ensure that you DO NOT post photos of students (other than your own) on facebook, Instagram, twitter etc. without the permission of their parents.



Change of details—Call the school to update your details on 9342 7377 or email mreyes@eccs.wa.edu.au



Emergency contacts—these are very important in the case that your child becomes sick or injured, and we are unable to reach you. Check with us in the office if you are unsure what details we have on file.



Check the school website for previous newsletter editions and other news

www.eccs.wa.edu.au

CLASSROOM NEWS

Year 8 STEM Building a straw bridge

In Term 2 for STEM the year 8 class worked on creating a bridge out of drinking straws and tape. The base was a square wooden block on each side and we used criss cross patterns to help support the bridge. Each group had 4 members who then split into 2 pairs and constructed the beams (75cms tall).



the beams both pairs came together and built the top of the bridge (50cms wide).

When the beam bridge was completed, we tested the strength of the bridge by placing materials (pencil case - 850gms) on the top the bridge to see for how long it can hold the materials without breaking or collapsing.

Moo Win & Victoria Pavkovic

In STEM (Science, Technology, Engineering and Mathematics) in term 2, the year 8 students designed and created a model beam bridge using plastic drinking straws and tape as their construction material. The goal was to build the strongest bridge with a truss pattern of our own design, while meeting the design criteria and financial constraints. Finally we experimented with different geometric shapes and determined how shapes affect the strength of the material.



Nazareth Kuhl



CLASSROOM NEWS

KINDERGARTEN

The Kindy Koala assembly was held on Thursday 15th June. They sang two songs 'Jesus is the Boss' and 'God Made the Weather'. The children were brightly dressed in raincoats and swim suits! A morning tea followed which was very well attended by parents and grandparents.



KINDY DATES		KANGAROO			KOALA			
Term 3	1	Staff only - PD		19-Jul		20-Jul	21-Jul	1
	2	24-Jul	25-Jul		26-Jul	27-Jul	28-Jul	2
	3	31-Jul	1-Aug	2-Aug		3-Aug	4-Aug	3
	4	7-Aug	8-Aug		9-Aug	10-Aug	11-Aug	4
	5	14-Aug	15-Aug	16-Aug		17-Aug	18-Aug	5
	6	21-Aug	22-Aug		23-Aug	24-Aug	25-Aug	6
	7	28-Aug	29-Aug	30-Aug		31-Aug	1-Sep	7
	8	4-Sep	5-Sep		6-Sep	7-Sep	8-Sep	8
	9	11-Sep	12-Sep	13-Sep		14-Sep	15-Sep	9
	10	18-Sep	19-Sep		20-Sep	21-Sep	Staff PD	10
Term 4	1	9-Oct	10-Oct	11-Oct		12-Oct	13-Oct	1
	2	16-Oct	17-Oct		18-Oct	19-Oct	20-Oct	2
	3	23-Oct	24-Oct	25-Oct		26-Oct	27-Oct	3
	4	30-Oct	31-Oct		1-Nov	2-Nov	3-Nov	4
	5	6-Nov	7-Nov	8-Nov		9-Nov	10-Nov	5
	6	13-Nov	14-Nov		15-Nov	16-Nov	17-Nov	6
	7	20-Nov	21-Nov	22-Nov		23-Nov	24-Nov	7
	8	27-Nov	28-Nov		29-Nov	30-Nov	1-Dec	8