



# Emmanuel Messenger

Term 1 | Issue 03 - 01 March 2017

## Vision

*Through the teaching of God's Word we will bring people to Christ and help them to grow in him.*

**Mathew 28:19-20**

## Contents

- Classroom news
- School Start & Finish times
- Important Dates for Term 1
- Traffic flow
- Information in brief
- Other Information
- Community News

## Principal's Message

# 40 Days of Prayer and Fasting



### **Why Pray and Fast for 40 days?**

We are servants in God's vineyard from whom He expects fruit. (Mark 12:2, Matthew 21: 28-41, Luke 13:6-7, John 15:8)

**Fruit in your Life:** As you meditate on God and His Word and abide in deepening intimacy with Jesus Christ, His transforming likeness will become more evident in your life!

**Fruit in your Local Sphere of Influence:** Pray that those you meet will encounter Jesus and his love, joy, peace, patience, kindness, goodness, faithfulness, gentleness, self-control... through you!

**Fruit in our Cities and Nation:** Pray for God's Church in your city and the people of your region with Jesus' prayer that we be one with God and each other. As you obey the Spirit's convictions from God's Word - you will see your Father's will done and His Kingdom come!

**Fasting for Fruitfulness!** Hunger for God's intervention in our cities! Denying your appetite for something focuses you beyond yourself! You might give up a meal or two per day, or desserts or TV or not eat for two or more days a week or only have fruit juice for 40 days.

### **Steps for Daily Scriptural Meditation.**

Set time aside to meditate on the texts in the Bible allowing a picture to form in your heart/mind.

1. What is today's Word saying to your heart? Invite the Holy Spirit to deeply examine, cleanse and convict you. Is God asking you to change how you usually think or act?
2. What will your life look like if you fully receive this Word as a seed in your life? Claim God's Word as His promise to you! Open your heart with expectant faith to the transformation your God can begin in you! (Mark 4, especially verses 14-20)
3. How will you actively nurture this Word into new fruit in your life? Daily focus and abiding will enable your choices, vocabulary, speech and lifestyle to match the new picture that the Word of God is painting in your heart!
4. What would your world (family, church, community, city) look like if you act on this Word together? (Matthew 18:18-20) Pray God's will and Kingdom comes on earth! Expectantly release to your world all you have been given.

**Address** 3 Salcott Road,  
Girrawheen WA 6064

**Phone** 9342 7377 **Fax** 9342 8286

**Email** emmanuel@eccs.wa.edu.au

[www.eccs.wa.edu.au](http://www.eccs.wa.edu.au)



# CLASSROOM NEWS

## Years 5 & 6



WESTERN AUSTRALIAN  
Electoral Commission

On Wednesday, Louis from the WA Electoral Commission visited our Year 5 and 6's. He explained to them how the three levels of government and the voting system works in WA. To ensure we fully understood the voting system, he selected four candidates being 'Seafood', 'Chicken', 'Steak' and 'Pasta' (aka Ben, Angelica, Enrico and Nasa). With mouths watering thinking about their favourite food choices, all the students completed their ballot paper to vote for their most preferred food option. Then counting began. It was a tight race to the finish between chicken and pasta but, to the delight of many, pasta came through as the most preferred food option.



ECSS would like to thank Louis for taking the time to visit our school, explain this important system to us and for leaving each student with a mini ballot box to keep.



# CLASSROOM NEWS

High School

## TABLE TENNIS

This year, ECCS has purchased 2 table tennis tables for our high school students to use during their lunch time breaks.



Mr Gabrielson and Mr C will be organising a round robin tournament for high school students to find out who in the school is the KING of PING PONG!

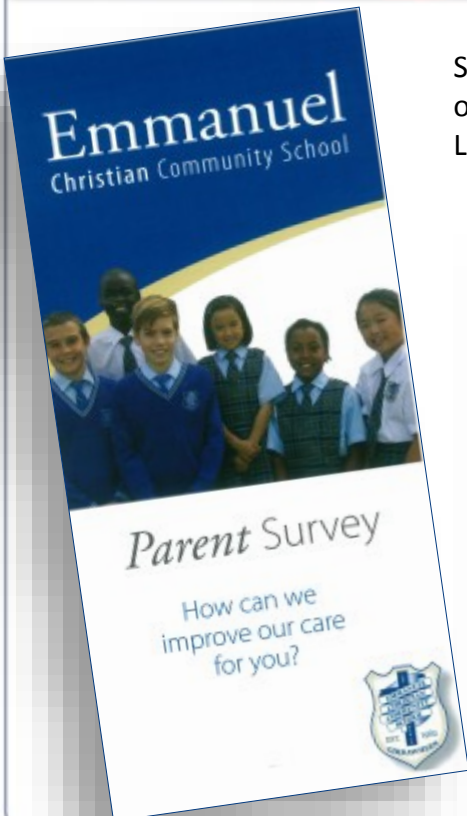
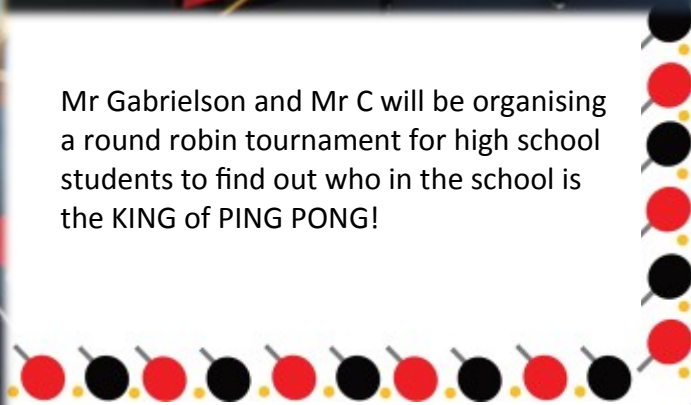

Surveys can be returned to the box in the school office when completed. There is a box in the Early Learning Centre foyer at Casserley Campus



**Emmanuel Christian Community School**

He has showed you, O man, what is good. And what does the Lord require of you? To act justly and to love mercy and to walk humbly with your God.  
Micah 6:8

The way we work together as a community is integral to our service.

**We aim to:**

- Use every encounter as an opportunity to serve Christ
- Be compassionate
- Be courteous
- Be community oriented
- Be willing to hear feedback to improve our service
- Work as a team

When one is helping the other, both are strong.

**PARENT SURVEY**  
How can we improve our care for you?  
Please tick the box that best represents your opinion on each statement. You are asked to tick Agree, Disagree or Sometimes.

ITEMS	Agree	Sometimes	Disagree
Overall I am happy with the school.			
My child enjoys attending the school.			
Christian values are an integral part of this school.			
The school values prayer.			
The office staff are courteous and helpful.			
The buildings and grounds are kept clean.			
The Principal is courteous, helpful and available to meet with me.			
The Deputy Principal is courteous, helpful and available to meet with me.			
Teachers at the school encourage my child to achieve their best.			
The teachers inform me of my child's behaviour and academic progress on a regular basis.			
Student reports are informative and easy to understand.			
I understand the role of the School Board.			
I read the school newsletters.			
The school provides programs consistent with what it advertises.			
As a parent, I feel welcome in the community.			
I understand the privacy policy and the school applies it well.			
When issues arise I feel free to openly express my views.			
Conflict resolution is dealt with promptly and fairly.			
I read the school Parent Handbook.			

You can have your say:

- Some things I appreciate or enjoy at Emmanuel are: \_\_\_\_\_
- An improvement I would like to suggest: \_\_\_\_\_
- I chose this school because: \_\_\_\_\_

Thank you for your feedback. PLEASE RETURN TO THE BOX IN SCHOOL OFFICE WHEN COMPLETED

# TERM 1 - IMPORTANT DATES

TERM 1		
MONDAY	01 FEBRUARY	TERM 1 BEGINS
TUESDAY	01 MARCH	40 DAYS OF PRAYER STARTS
MONDAY FRIDAY	27 FEB — 10 MARCH	SWIMMING YEARS 3— 6
TUESDAY	07 MARCH	YEAR 8 VACCINATION
THURSDAY	02 MARCH	YEAR 2 ASSEMBLY
<b>MONDAY</b>	<b>06 MARCH</b>	<b>LABOUR DAY HOLIDAY</b>
THURSDAY	09 MARCH	COUNCILLORS ASSEMBLY
FRIDAY SUNDAY	10 MARCH— 12 MARCH	LEADERSHIP CAMP
THURSDAY	16 MARCH	YEAR 3 ASSEMBLY
MONDAY	27 MARCH	PARENTS NIGHT (7 PM)
FRIDAY	31 MARCH	SWIMMING CARNIVAL
<b>**SUNDAY</b>	02 APRIL	SCHOOL CHURCH SERVICE & SCHOOL AGM**
TUESDAY	04 APRIL	OFFICIAL OPENING OF CASSERLEY CAMPUS
WEDNESDAY	05 APRIL	YEAR 6 MASQUERADE
THURSDAY	06 APRIL	SCHOOL EASTER SERVICE
<b>THURSDAY</b>	<b>06 APRIL</b>	<b>END OF TERM 1</b>

SCHOOL START/FINISH TIMES	
<b>KINDERGARTEN &amp; PRE PRIMARY</b>	
BEGINS	8:30am
Yellow Late slips are required after 9am	
ENDS	3:15 pm
<b>YEARS 1—9</b>	
BEGINS	8:30 AM
Yellow Late slips are required after 9am	
RECESS	10:30 — 10:50 AM
Years 1-6 LUNCH	12:15 — 1:05 PM
Years 7-9 LUNCH	12:30—1:05 PM
<b>END OF SCHOOL</b>	<b>3:15 PM</b>



**The Uniform Shop**  
Shop Hours  
**MONDAYS: 8:30—9:30 am**  
**THURSDAYS: 3:00—3:30 pm**  
**CASH ONLY!**

**\*\*The Annual School Church Service is a compulsory event for ALL PP - YEAR 9 students. (Kindy NOT COMPULSORY but invited to attend) and all families are also invited to come watch and enjoy seeing the students on display, as they participate in the service. The service this year is on **Sunday 2nd April 10:15—12pm**. Keep the date free!\*\***

## Class Assemblies - 2017

TERM 1			TERM 2		
THURSDAY	02 MARCH	YEAR 2	THURSDAY	25 MAY	YEAR 1
THURSDAY	16 MARCH	YEAR 3	THURSDAY	08 JUNE	KINDY KOALA

# TRAFFIC FLOW & PARKING

## MORNING & AFTERNOON TRAFFIC FLOW & PARKING

THANK YOU FOR SLOWING DOWN & FOLLOWING THE TRAFFIC FLOW CORRECTLY. (SEE MAP BELOW). The safety of our students always comes FIRST! It only adds about 30 seconds to your journey TO ALWAYS TURN LEFT into Hainsworth Road, turn at the roundabout and continue. This allows traffic to flow, keeps our local community happy and our students safe.



### WHY?

- ⇒ The Safety of our children
- ⇒ Relationships with neighbours and residents

### DO

- ⇒ Enter Salcott Road North
- ⇒ Turn Left at Hainsworth Avenue
- ⇒ Obey instructions of staff on duty

### DON'T

- ⇒ Drop off children outside school grounds and allow them to walk across the car park

All Upper School traffic MUST enter Salcott Road here

## Location Map and traffic flow

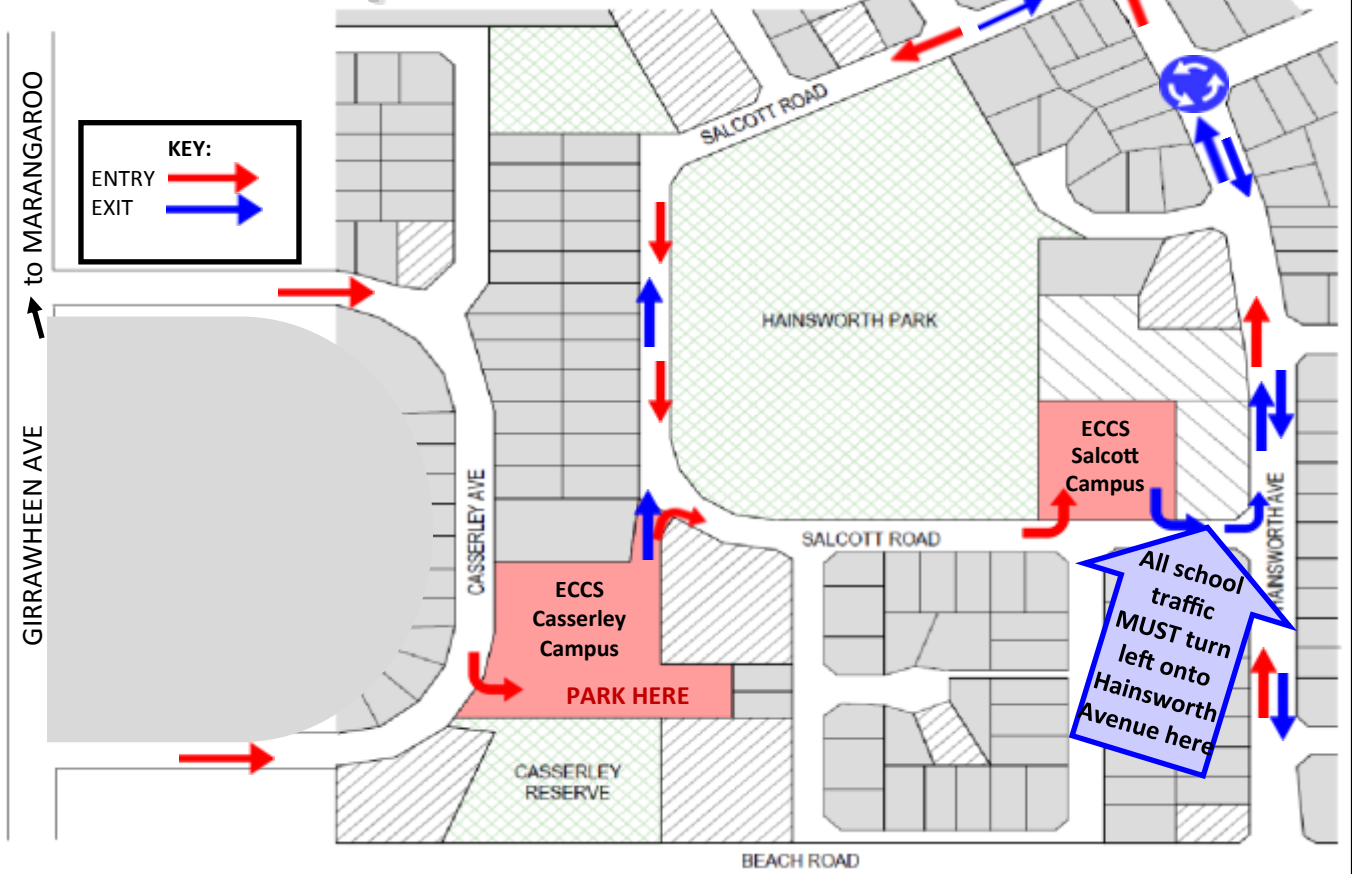

**Reminder that there is NO DRIVE THROUGH STUDENT DROP OFF OR PICK UP AT CASSERLEY CAMPUS due to safety concerns.**

**WE STRONGLY ENCOURAGE PARENTS TO:**

⇒ ENTER the school at Casserley Avenue entrance  
 ⇒ PARK the car, collect children, then drive straight out the exit gates

OR

⇒ PARK near oval IN PARKING BAYS PROVIDED  
 ⇒ Walk on footpath to Casserley Campus  
 ⇒ COLLECT children and return to car using the footpath

# INFORMATION IN BRIEF



**Swimming lessons**—continue for Years 3-6 every afternoon until Friday 10th March.

**Swimming training**—also continues before school for selected students who are representing our school at the interschool carnival on 31st March.



**Uniform Shop**—is open every Monday morning (8:30-9:30am) and Thursday afternoon (3:00-3:30pm). Hats are back in stock! Winter uniforms coming soon.



**Subway Lunches**—Forms to be returned by THURSDAY morning. Lunch delivered every Friday

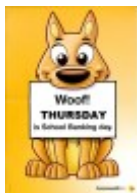

**School Banking**—Every Thursday morning from 8am to 8:30am at BOTH campuses. Come and visit for more information



**Homework club**—Every Thursday afternoon from 3:20-4:15pm. Now FULL for Term 1. Collect a form from the office and reserve a spot for next term.



**Parents Prayer group**—Fortnightly on Friday mornings 8:45-9:15 in the Church hall. Next prayer meeting is Friday 3rd March.



**Check out our website for previous newsletters. These include more detailed information on school & community events**

**School Fees**—are now 2 weeks **overdue**. Please attend to this urgently if you have fees outstanding and no payment plan in place.

**Social Media**—Please ensure that you DO NOT post photos of students (other than your own) on facebook, Instagram, twitter etc. without the permission of their parents.

**Change of details**—have you moved?? Got a new phone?? Call the school to update your details on 9342 7377 or email [mreyes@eccs.wa.edu.au](mailto:mreyes@eccs.wa.edu.au)

**Emergency contacts**—these are very important in the case that your child becomes sick or injured, and we are unable to reach you. Check with us in the office if you are unsure what details we have on file.

**Dental forms** - if your child has been given a dental form from Hudson Park Dental Centre, please return it to a teacher/office asap. If you have misplaced the form, you can call the dental centre on 9342 4217 and they will send a new one.

UnPaid  
BILLS



**JCE**  
Junior  
Christian  
Endeavour

**WHO?** All kids from Kindy to grade 6.

**WHEN?** Every Friday during School term

**TIME?** 5:30—7pm

**WHERE?** Girrawheen Baptist Church premises

**WHAT?** Meet other friends & learn more about Jesus in a fun and loving environment.

# OTHER INFORMATION

## PARENT PRAYER GROUP



We welcome all parents to join us in a short time of prayer fortnightly on Friday mornings in the minor church hall. This is a great way to meet other parents if you are new to Emmanuel, and a great way to bless our school community. We welcome all prayers, including those who speak other languages, and those who prefer to pray quietly in their hearts, God always hears! Come at 8:30 for a cup of tea, we pray from 8:45 - 9:15am. Also please feel free to leave prayer requests in the box in the school office.

**NEXT PRAYER MEETING THIS FRIDAY, 3rd March. We hope to see you :)**

## VOLUNTEERS NEEDED!



We would like to get the details of parents, carers or other family members available to help at various school events throughout the year. If **EACH FAMILY HAD ONE PERSON** help for two hours each year, that would be **274 hours**!!!! Sharing the load is a loving, fair way to be part of our Emmanuel School Community. **WE NEED YOUR HELP!!! Please register your details in the office** if you have any spare time you can allocate to volunteer at the school.

**Need a card?**

## BOOK ROOM

**Last minute gift?**

The School Book Room is part of the ministry of Girrawheen Baptist Church and is situated next door to the School Office. They sell a huge variety of Christian materials and resources from books, Bibles, calendars, greeting cards, pens, toys, CD's, DVD's etc. Students enjoy visiting our book room during their breaks and it's also a good place to buy small items for gifts to friends and families.

**Any profit made by the Book Room goes towards supporting 5 Compassion children.**

**Come and check out the range of items we have in store!!**



**OPENING TIMES:**

**Mondays**  
8:30 — 1:00  
**Thursdays**  
8:30 — 1:00  
**Sundays**  
12 — 12:30



**Play group** is a great place for Pre-kindly siblings to come & get to know other children that may also attend Emmanuel with them. Run by the Girrawheen Baptist Church, we now meet in the old Kindy facilities (2 Salcott Rd). Thank you to High school Staff and Students for enabling this to happen on Wednesdays.

**Time:** 9-11am **Cost:** \$2.50 per child (babies free)

**Bring:** 1 piece of fruit to share

**Free Play** (Painting, Playdough, Riding bikes, Slides, Sandpit, Puzzles etc.) **Craft/gluing, Morning Tea** (Fruit & sandwiches), **Story & Singing.**

**Phone Margaret on 0411 431 300 for more information**

# COMMUNITY NEWS